

CDL-01-SET

Double Glass Door Lock With Lock Case



ALWAYS REFERENCE DIMENSIONS
TO ENSURE ACCURACY

*Not shown to scale.



CDL-04-HND

Modern styled lever handle



CDL-03-HND

Tubular styled lever handle



CDL-02-HND

Square styled lever handle

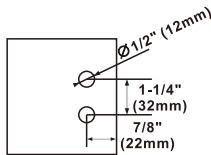
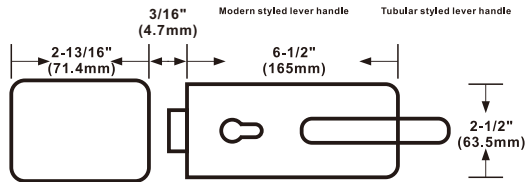

(LOCK CASE)

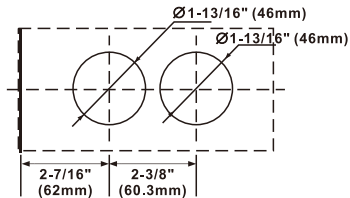

(LOCK BODY)

Specifications

Material: 304 Stainless steel

Suited door thickness: $3/8-9/16"$ (10-15mm) safe glass

Recommendations:

To ensure public safety, we strongly advise using only tempered safety glass.

UNIKOO LIMITED WARRANTY:

- UNIKOO warrants its hardware for a period of 1 year from the date of purchase. UNIKOO hardware is warranted against material and workmanship defects. All warranty claims are subject to inspection by UNIKOO before providing a resolution against the warranty claim.
- This warranty is void if it is determined after UNIKOO inspection that the Hardware has been improperly installed and/or maintained in a manner not conforming to UNIKOO guidelines and instructions provided at time of purchase.
- UNIKOO's responsibility to provide a resolution under said warranty will be limited to a refund of purchased price or provide a replacement for the hardware.

The refund or replacement will constitute UNIKOO's limited liability and obligation for any and all defective material/workmanship for said warranty claim.

- THIS WARRANTY IS EXCLUSIVE AND UNIKOO MAKES NO OTHER WARRANTY, EXPRESSED OR IMPLIED.